

三通先导型电磁阀

3 Way Pilot Type Solenoid Valve

TVZ300,500 Series

图形符号

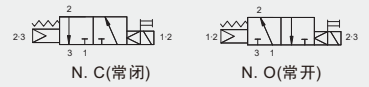

Common Specification (共同规格)

Model No. (型号)	TVZ312	TVZ512
Fluid (流体)	Clean Air (洁净空气)	
Press (使用压力)	0.15~0.7MPa	
Effective Sectional Area (有效截面积)	3.6mm ² (CV=0.2)	6mm ² (CV=0.33)
Ambient Temp. (环境温度)	Max. (最高) 50°C	
Max. Cycles (最大操作频率)	5c/s (次/秒)	
Response Time (应答时间)	≤20ms	
Lubrication (润滑)	Not Required (不需要)	
Power Consumption (电力消耗)	1.8W(DC)	

How To Order (型号表示方法)

TVZ 3 12 - 3 G - M5 A

Series 系列	Rated Voltage 额定电压	Connection 接电方式	Port Size 接管口径	Function 阀形式
3 M5	3 AC110V	G Grommet(直接出线式)	M5 For TVZ312	A N.C(常闭)
5 1/8"	4 AC220V	L L Type Terminal(L型插座式)	1/8 For TVZ512	B N.O(常开)
	5 DC24V	LZ L Type Terminal(插座式) /LED&Varistor(带指示灯和 过压抑制器)		
	6 DC12V	DZ Din Type Terminal(插座式) /LED&Varistor(带指示灯和 过压抑制器)		

Dimensions(mm)(外形尺寸图(毫米))

TVZ312-□L/LZ/DZ

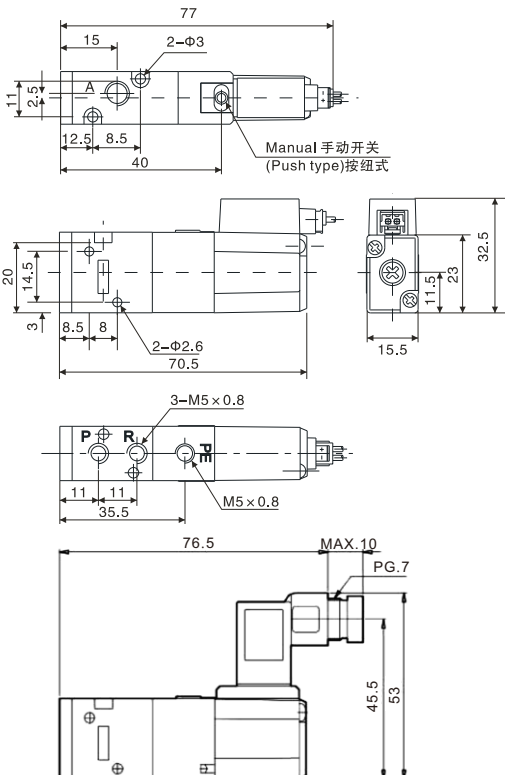

TVZ512-□L/LZ/DZ

