



Features(产品特点)

- 1.5 bellow & flat vacuum pad
- Transfer objects in the vertical plane steadily and safely, there is good lifting force.
- Strong adsorptive power, good wear resistance.
- 波纹扁平吸盘1.5折。
- 平面与产品水平垂直传送，平稳安全。
- 吸附力强，优良的耐磨性。

How To Order(型号表示方法)

SBF80 PU - 12F - EQ - KI1230-A18 - BH-G1/2

① ② ③ ④ ⑤ ⑥

① Model(型号)

SBF30	φ30
SBF40	φ40
SBF50	φ50
SBF60	φ60
SBF80	φ80
SBF100	φ100

② Material(Shore Hardness)(材质(肖氏硬度))

PU	Poly Urethane(聚氨酯)(60°)
----	-------------------------

③ Connection thread(连接螺纹)

18-F	G1/8 Female Thread(内螺旋)(SBF30,40,50,60,80,100)
14-F	G1/4 Female Thread(内螺旋)(SBF30,40,50,60,80,100)
38-F	G3/8 Female Thread(内螺旋)(SBF30,40,50,60,80,100)
12-F	G1/2 Female Thread(内螺旋)(SBF60,80,100)
14-M	G1/4 Male Thread(外螺旋)(SBF30,40,50,60,80,100)
M10M	M10 x 1.5 Male Thread(外螺旋)(SBF30,40,50,60,80)

④ Quick Mount Sdaptor\*(快速安装接口)

EQ	Quick Mount Adaptor*(快速安装接口)
-	No(无)

\*Only for G3/8\*female and spring plunger is not available  
\*仅适用于G3/8螺母，不能与弹簧缓冲支杆一起使用

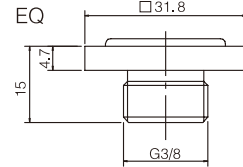

⑥ Springplunger(弹簧缓冲支杆)

Model(型号)	Buffer Stroke (缓冲行程)(mm)	7 Ball Joint (球状接头)	
KE1810-A16, KE1810-L-A14, KE1810-V-A16	10	BH-G1/8	
KE1820-A16, KE1820-L-A14, KE1820-V-A16	20		
KE1830-A16, KE1830-L-A14, KE1830-V-A16	30		
KE1850-A16, KE1850-L-A14, KE1850-V-A16*	50		
KI1810-A16, KI1810-L-A16, KI1810-V-A16	10		
KI1820, KI1820-L-A16, KI1820-V-A16*	20		
KI1830-A16, KI1830-L-A16, KI1830-V-A16	30		
KI1850-A16, KI1850-L-A16, KI1850-V-A16*	50		
KE1210-L-A20, KE1210-A20	10		BH-G1/2
KE1220-L-A20, KE1220-A20	20		
KE1230-L-A20, KE1230-A20	30		
KE1250-L-A20, KE1250-A20	50		
KI1210-L-A20, KI1210-A18, KI1210-A22	10		
KI1220-L-A20, KI1220-A18, KI1220-A22	20		
KI1230-L-A20, KI1230-A18, KI1230-A22	30		
KI1250-L-A20, KI1250-A18, KI1250-A22	50		

\*Not available with ball joint.\* 不能与球状接头共同使用

Recommended(Max.) Lifting Force(N)(不同真空度的最大传力)

Model (型号)	Volume (内部容量)cm <sup>3</sup>	Vertical Lifting Force (垂直传力)(N)			Parallel Lifting Force (水平传力)(N)		
		-20kPa	-60kPa	-90kPa	-20kPa	-60kPa	-90kPa
SBF30	6	11	60.2	91	8.4	30.5	76
SBF40	7.2	17.5	93	119.8	11.3	63.8	110.8
SBF50	11	25	128.5	157.8	20.5	94	144
SBF60	22	87.3	156.2	189.2	67	125.6	165.8
SBF80	59.5	118.6	210.5	252.6	89	167.8	221.2
SBF100	103.5	149	269.5	310.4	111.8	209.8	276.5

Dimensions (mm)(外形尺寸(毫米))

↓ SBF30PU/40PU/50PU

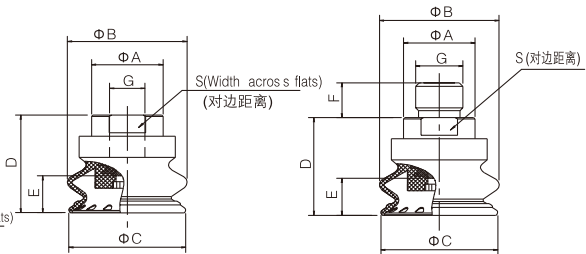

← SBF60PU/80PU/100PU

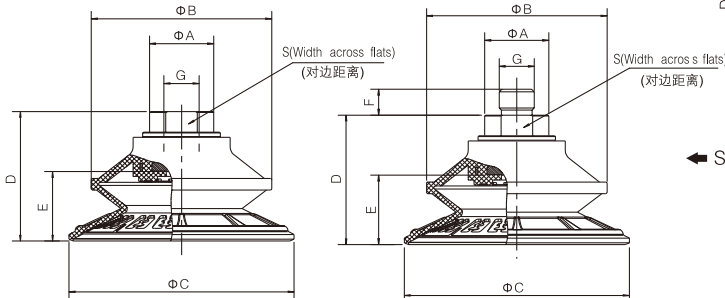

Dimensions (mm)(外形尺寸(毫米))

Model(型号)	ΦA	ΦB	ΦC	D	E	F	G	S Width Across Flats(六角对边)
SBF 30PU-18F	19.8	32	32	28	7	-	G1/8 Female Thread(内螺纹)	17
SBF 30PU-14F	19.8			28		-	G1/4 Female Thread(内螺纹)	17
SBF 30PU-38F	-			44		-	G3/8 Female Thread(内螺纹)	17
SBF 30PU-14M	19.8			28		10	G1/4 Male Thread(外螺纹)	17
SBF 30PU-M10M	16.8			28		12	M10x1.5 Male Thread(外螺纹)	17
SBF 40PU-18F	19.8	32	42	29	9	-	G1/8 Female Thread(内螺纹)	17
SBF 40PU-14F	19.8			29		-	G1/4 Female Thread(内螺纹)	17
SBF 40PU-38F	-			45		-	G3/8 Female Thread(内螺纹)	17
SBF 40PU-14M	19.8			29		10	G1/4 Male Thread(外螺纹)	17
SBF 40PU-M10M	16.8			29		12	M10x1.5 Male Thread(外螺纹)	17
SBF 50PU-18F	24.8	40	51.5	37	11.5	-	G1/8 Female Thread(内螺纹)	22
SBF 50PU-14F	24.8			37		-	G1/4 Female Thread(内螺纹)	22
SBF 50PU-38F	24.8			37		-	G3/8 Female Thread(内螺纹)	22
SBF 50PU-14M	24.8			37		10	G1/4 Male Thread(外螺纹)	22
SBF 50PU-M10M	24.8			37		12	M10x1.5 Male Thread(外螺纹)	22
SBF 60PU-18F	24	50	64	41.5	15	-	G1/8 Female Thread(内螺纹)	21
SBF 60PU-14F	24			41.5		-	G1/4 Female Thread(内螺纹)	21
SBF 60PU-38F	24			41.5		-	G3/8 Female Thread(内螺纹)	21
SBF 60PU-12F	29			41.5		-	G1/2 Female Thread(内螺纹)	26
SBF 60PU-14M	24			41.5		10	G1/4 Male Thread(外螺纹)	21
SBF 60PU-M10M	24			41.5		12	M10x1.5 Male Thread(外螺纹)	21
SBF 80PU-18F	24	68	84	49.5	22.5	-	G1/8 Female Thread(内螺纹)	21
SBF 80PU-14F	24			49.5		-	G1/4 Female Thread(内螺纹)	21
SBF 80PU-38F	24			49.5		-	G3/8 Female Thread(内螺纹)	21
SBF 80PU-12F	29			49.5		-	G1/2 Female Thread(内螺纹)	26
SBF 80PU-14M	24			49.5		10	G1/4 Male Thread(外螺纹)	21
SBF 80PU-M10M	24			49.5		12	M10x1.5 Male Thread(外螺纹)	21
SBF 100PU-18F	24	83	103	55	20.5	-	G1/8 Female Thread(内螺纹)	22
SBF 100PU-14F	24			55		-	G1/4 Female Thread(内螺纹)	22
SBF 100PU-38F	24			55		-	G3/8 Female Thread(内螺纹)	22
SBF 100PU-12F	27			55		-	G1/2 Female Thread(内螺纹)	24
SBF 100PU-14M	24			55		10	G1/4 Male Thread(外螺纹)	22

(mm)