

### STC Series



#### Features(特征)

- Various sizes, suitable for workpiece with different shapes and sizes
- Large inner support structure protects the metal sheets from deformation and damage during handling process
- Slot structure efficiently increases the friction force between vacuum pad and workpiece in order to prevent the oily metal sheets from slipping during the process of handling
- 1.5 bellows structure has good sealing and buffer to workpiece with uneven surface
- Vacuum pads are available with various connection types
- 尺寸型号齐全，适合不同形状和尺寸的工件
- 内部大面积支撑结构，能有效保护金属薄板在搬运过程中免于变形损伤
- 凹槽式内部支撑结构，有效增大吸盘与工件接触面摩擦力，防止油性金属板搬运过程中发生侧滑
- 1.5折折叠波纹结构，对于搬运表面不平整的工件具有良好的密封性，搬运过程中具有缓冲作用
- 吸盘有多种连接方式可供选择

#### Applications(适用范围)

- Car stamped steel plates with irregular shapes
- Steel plates with oily surface
- Glass, stamping parts, plywood
- Handling normal sheet metal (in order to avoid deformation)
- 不规则形状的汽车冲压钢板
- 油性表面类钢板
- 玻璃、冲压件、胶合板
- 普通金属薄板搬运(防止变形)

#### Model(型号规格)

Model(型号)	Diameter(mm)(直径)	Material And Hardness(材质及硬度)	Connection Thread(连接螺纹规格)
STC	22	N-60(Orange)(N-NBR) N-60(橙色)(N-NBR)	G1/4M (M-Male Thread)(M-外螺纹) G1/4F (F-Female Thread)(F-内螺纹) G3/8F M10M M14X1.5M RA Rectangular Tdapter(RA矩形适配器)
	30		
	40		
	50		
	60		
	80		
	100		

#### Technical Parameters(性能参数)

Model(型号)	Vertical Pull-out Force(N)(垂直拉脱力)(N) -60kPa	Lateral Pull-out Force(N)(横向拉脱力)(N) -60kPa	Lateral Pull-Out Force On Oily Surface(N)(油性表面横向拉脱力)(N) -60kPa	Inner Volume(cm <sup>3</sup> )(内部体积)	Min. Curve Radius of Workpiece(cm)(工件最小曲率半径)	Recommended Tube Diameter(mm)(推荐软管直径)	Weight(g)(重量)
STC22	23	20	6.5	1.5	20	4	8.6
STC30	35	28	12	6.3	35	4	12-23
STC40	62	37	34	7.2	35	4	13.5-24
STC50	85	58	55	11.2	45	6	21-31
STC60	141	88	83	22.5	52	6	29-39
STC80	236	141	136	57	70.5	6	51-61
STC100	371	228	221	92	95	6	77-87

△ Workpiece is with smooth, dry surface, the above pull-out force datas don't include a safety factor.

Values may change according to different workpiece surfaces.

△ 测量工件表面光滑、干燥。以上拉脱力数据不包括安全系数。根据工件表面状况不同，数值可能会有变化。

#### Dimensions(mm)(外形尺寸图(毫米))

STC22-STC100(Female thread)(内螺纹)

STC22-STC100(Male thread)(外螺纹)

STC22-STC100 RA(Rectangular adapter)(RA矩形适配器)

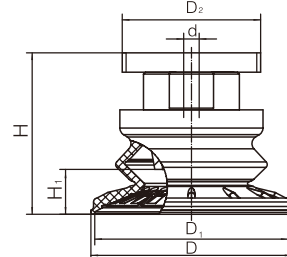
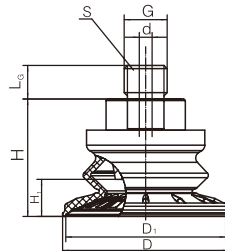
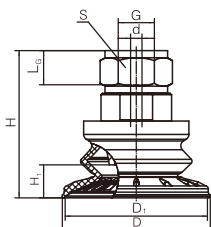

Dimensions (mm)(外形尺寸(毫米))

Size (mm) Model(型号)	D	D <sub>1</sub>	d	G	H	L <sub>G</sub>	D <sub>2</sub>	S	H <sub>1</sub>
STC22N-60-G1/4F	22	20	4	G1/4F	25	12	--	16	5.5
STC22N-60-G1/4M	22	20	4	G1/4M	25	12	--	16	5.5
STC22N-60-G3/8F	22	20	4	G3/8F	39	11	--	22	5.5
STC22N-60-M10M	22	20	4	M10M	25	12	--	16	5.5
STC22N-60-M14M	22	20	4	M14X1.5M	25	12	--	16	5.5
STC22N-60-RA	22	20	4	--	33	--	32	--	5.5
STC30N-60-G1/4F	32	30	4	G1/4F	28	12	--	17	9.5
STC30N-60-G1/4M	32	30	4	G1/4M	28	12	--	17	9.5
STC30N-60-G3/8F	32	30	4	G3/8F	42	11	--	22	9.5
STC30N-60-M10M	32	30	4	M10M	28	12	--	17	9.5
STC30N-60-M14M	32	30	4	M14X1.5M	28	12	--	17	9.5
STC30N-60-RA	32	30	4	--	33	--	32	--	9.5
STC40N-60-G1/4F	42	40	4	G1/4F	28.5	12	--	17	10
STC40N-60-G1/4M	42	40	4	G1/4M	28.5	12	--	17	10
STC40N-60-G3/8F	42	40	4	G3/8F	42.5	11	--	22	10
STC40N-60-M10M	42	40	4	M10M	21.5	12	--	17	10
STC40N-60-M14M	42	40	4	M14M	21.5	12	--	17	10
STC40N-60-RA	42	40	4	--	33.5	--	32	--	10
STC50N-60-G1/4F	52	50	6	G1/4F	51	11	--	22	11.5
STC50N-60-G1/4M	52	50	6	G1/4M	37	12	--	22	11.5
STC50N-60-G3/8F	52	50	6	G3/8F	37	15	--	22	11.5
STC50N-60-M10M	52	50	4	M10M	37	12	--	22	11.5
STC50N-60-M14M	52	50	6	M14M	37	12	--	22	11.5
STC50N-60-RA	52	50	6	--	42	--	32	--	11.5
STC60N-60-G1/4F	62.5	60	6	G1/4F	55	11	--	22	14.5
STC60N-60-G1/4M	62.5	60	6	G1/4M	41	12	--	22	14.5
STC60N-60-G3/8F	62.5	60	6	G3/8F	41	15	--	22	14.5
STC60N-60-M10M	62.5	60	4	M10M	41	12	--	22	14.5
STC60N-60-M14M	62.5	60	6	M14M	41	12	--	22	14.5
STC60N-60-RA	62.5	60	6	--	46	--	32	--	14.5
STC80N-60-G1/4F	82	80	6	G1/4F	64.5	11	--	22	22.5
STC80N-60-G1/4M	82	80	6	G1/4M	50.5	12	--	22	22.5
STC80N-60-G3/8F	82	80	6	G3/8F	50.5	15	--	22	22.5
STC80N-60-M10M	82	80	4	M10M	50.5	12	--	22	22.5
STC80N-60-M14M	82	80	6	M14M	50.5	12	--	22	22.5
STC80N-60-RA	82	80	6	--	55.5	--	32	--	22.5
STC100N-60-G1/4F	102.5	100	6	G1/4F	70	11	--	22	25
STC100N-60-G1/4M	102.5	100	6	G1/4M	56	12	--	22	25
STC100N-60-G3/8F	102.5	100	6	G3/8F	56	15	--	22	25
STC100N-60-M10M	102.5	100	4	M10M	56	12	--	22	25
STC100N-60-M14M	102.5	100	6	M14M	56	12	--	22	25
STC100N-60-RA	102.5	100	6	--	61.5	--	32	--	25