

薄型回转摆动气缸/齿杆型 Compact Rack & Pinion Type Cylinder

TCRQ Series

Feature (特征)

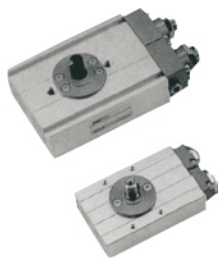

- Rotary cylinder by Rack & Pinion
- High precision positioning by minimized backlash in rotary end using double rack type
- Easier wire & pipe arrangement and operating due to inserting combined function between air
- Adjustable angle setting and cushion stroke
- Use synthetic resin on side part
- Possible to mount auto switches
- Suitable for valve open/close device, feeding part of assembly line
- 薄型齿杆型回转摆动气缸
- 双齿条方式
- 接管方便
- 缓冲行程调节和社顶角度可同时进行
- 可配磁性开关
- 移动部位以耐磨性合成树脂制成

How To Order (型号表示方法)

TCRQ 25 - 90 - M9B S

Bore 缸径	Rotation Angle 摆动角度	*Auto Switch 磁性开关
12, 16, 20, 25, 30	90° 90° 180° 180°	Nil(空) None (无磁性开关) M9B Reed Switch (带有接点磁性开关) M9NP Contactless Switch (无接点磁性开关)
		*Auto Switch (磁性开关) No. of Auto Switch 引线长度表示记号: 磁性开关数量 无记号-1m (标准) Nil(空) 2 (个) L -3m S 1 (个) Z-5m

Specification (规格)

Type (型号)	TCRQ12-90	TCRQ12-180	TCRQ16-90	TCRQ16-180	TCRQ20-90	TCRQ20-180	TCRQ25-90	TCRQ25-180	TCRQ30-90	TCRQ30-180
Cylinder Bore Size (缸径) (mm)	12		16		20		25		30	
Rotation Angle (回转角度)	90°	180°	90°	180°	90°	180°	90°	180°	90°	180°
Cushion Angle (缓冲角度)	Within Single-Angle (偏侧角度) 35° (范围)									
Cushion Type (缓冲)	Air Cushion (Adjustable) (气缓冲(调节式))									
Torque (理论力矩) (kgf.cm)	0.67 × P		1.4 × P		2.52 × P		4.9 × P		10.1 × P	
Allowable Energy (允许动能) (kgf.cm)	0.7		1.2		2.5		3.8		4.7	
Weight (本体重量) (kgf)	0.18	0.21	0.26	0.31	0.5	0.58	0.8	1.0	1.38	1.76
Air Port Size (接管口径)	M5		M5		M5		PT1/8		PT1/8	
Max. Radial Load (最大横向负载) (kgf)	0.8		1.4		4		8		11	
Max. Thrust Load (最大轴向负载) (kgf)	0.8		1.4		4		8		11	
Rotation Time (回转时间) (sec)	0.2~0.5	0.3~0.7	0.2~0.7	0.3~0.9	0.2~1.0	0.3~1.2	0.2~1.0	0.3~1.2	0.3~1.0	0.4~1.3
Working Fluid (使用流体)	Clean Air (洁净空气) (*注1)									
Operating Pressure (使用压力) (kgf/cm ²)	General resistance pressure: 10.5 (1.5~7 (普通耐压: 10.5))									
Lubrication (润滑)	Not Required (不需要) (*注2)									
Temperature (使用温度) (°C)	5~60									
Motion Type (工作方式)	Double Acting Type (双动) (Structure (机构部): RACK & PINION, Slide part (移送部): Plastic guide (合成树脂系列))									
Accuracy (精度) (mm)	± 0.05									
Auto Switch (磁性开关)	PRO-A1, A2 (Auto switch of direct contact type) (有接点磁性开关)									

Note 1) Clean Air is contained solidity of 99.9% fluid oil and 0.3% supersaturated wet through filtering 3~10μm

Note 2) Please Use Turbine Oil 1st-Grade ISOVG32, If Necessary.

注1) 洁净空气: 用3~10μm过滤器过滤掉99.9%水份和液体油含0.3%固体物的洁净空气。

注2) 如需要润滑, 请用透平1号油ISOVG32.

Dimensions (mm) (外形尺寸图 (毫米))

TCRQ12

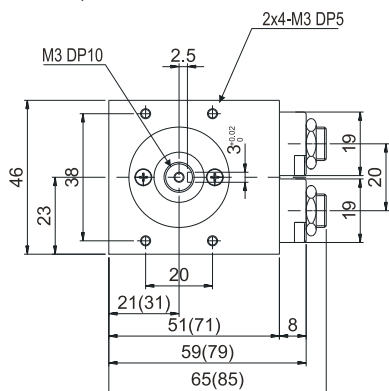

TCRQ12-M9B

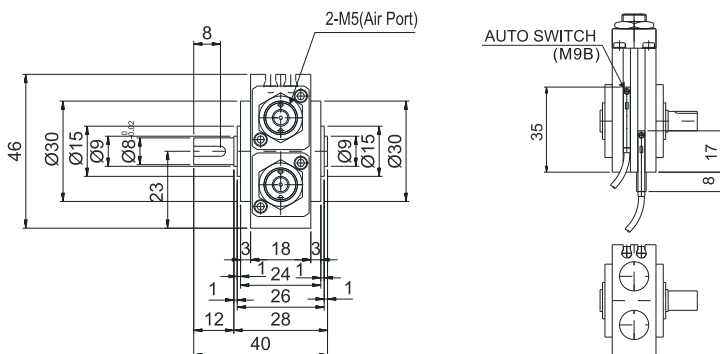

*()内的尺寸为180°型

Please contact us on any small problem and details.
更详细的图以及问题, 请直接与本公司联络。

薄型回转摆动气缸/齿杆型 Compact Rack & Pinion Type Cylinder

TCRQ Series

Dimensions(mm)(外形尺寸图(毫米))

TCRQ16

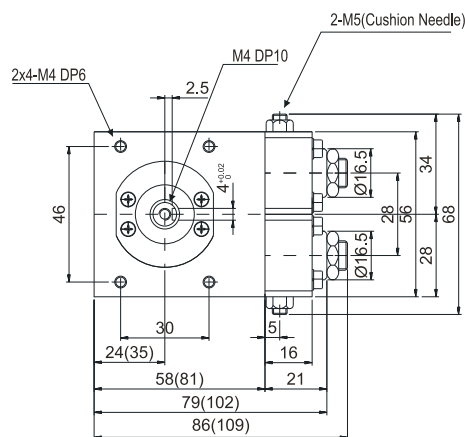

TCRQ16-M9B

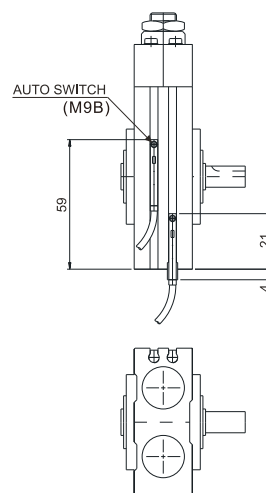

*()内的尺寸为180°型

Dimensions(mm)(外形尺寸图(毫米))

TCRQ20

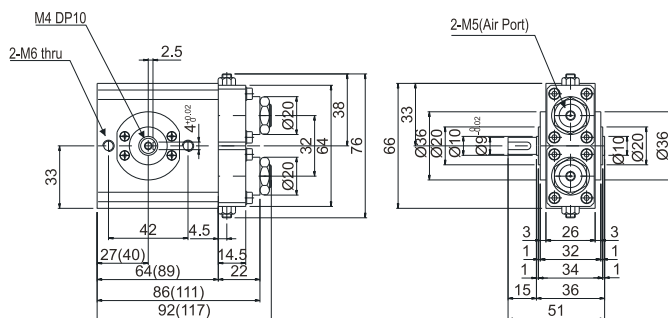

TCRQ20-M9B

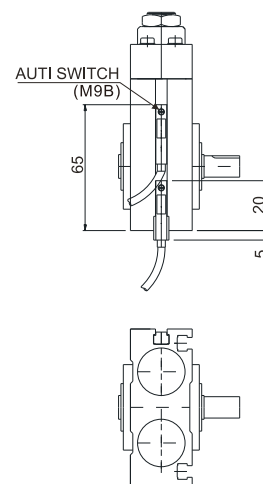

*()内的尺寸为180°型

