

压力开关 Pressure Switch

TSNS Series



Contact Function(接点形式)



↑ Pressure rise
↑ 表示压力上升

1	Common Terminal(共同点)
2	Close in, Pressure Decrease(压力上升接点)
3	Close on, Pressure Increase(压力下降接点)

General Description(概述)

- For use with fluorinated refrigerants as with air and water(Allowable Fluid Temp:-10 to 120°C)
- Type TSNS for Universal application.
- Micro-switch ensures reliable switching.
- Mounting Bracket supplied as standard.
- With SPDT contact mechanism.
- 冷冻, 冷却装置, 冷却水装置。(使用流体温度-10~120°C)
- 使用在 液压, 气压。
- 安装板以标准型供应

Electrical Function(电气功能)

Rated Voltage(V) (额定电压)		Power Factor (COS φ)	125/250V AC
Rated Amps. (额定电压) Non-Inductive Current		1	12
Inductive Current (感应电流)	Full Load	0.75	12
	Locked Rotor	0.45	72

Pressure Connections(接点构造)

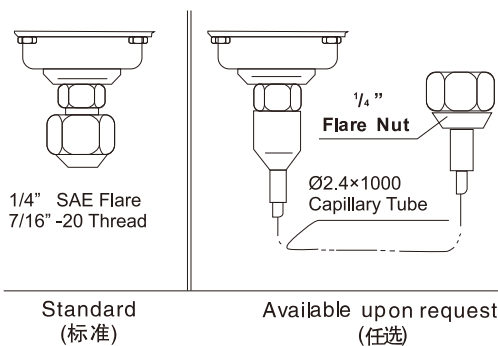

Mounting Bracket(标准安装板)

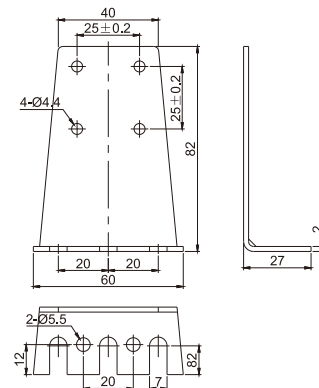

Dimensions(mm)(外形尺寸图(毫米))

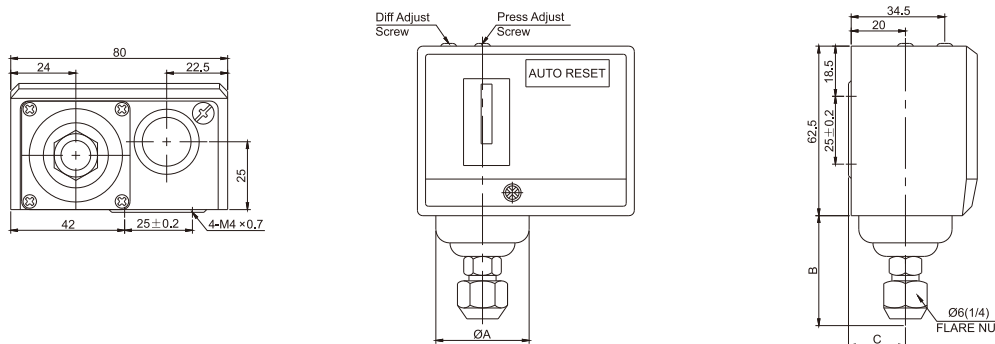

Model No.(型号)	Range(调整范围)(MPa)		Differential(输入压力差)(MPa)		Factory Setting(设定值)(MPa)		Max.Bellows Pressure (最高工作压力) MPa(kg/cm ²)	Wt (质量)	A	B	C
	Min.(最低)	Max.(最高)	Min.(最低)	Max.(最高)	OFF(ON)	ON(OFF)					
TSNS-	C103	-50cmHg	0.3	0.035	0.2	0.05	0.15	0.42kg	38.5	38.9	22.4
	C106	-50cmHg	0.6	0.06	0.4	0.2	0.3		34.4	36	22.4
	C110	0.1	1.0	0.1	0.3	0.4	0.6		34.4	36	22.4
	C120	0.5	2.0	0.3	0.5	1.5	1.2		22	32.7	18.5
	C130	0.5	3.0	0.3	1.0	2.0	1.5		4.0(40.0)		